



VXI indirect electrovalves, are particularly suitable to control water, air, inert gas, steam and for all fluids in general (not aggressive).
 The extremely compact stainless steel body, gives them the possibility to be used in very small places. They're available in different versions as 2/2, 3/2 NC and NO and with NBR, Viton or EPDM seals.

Les électrovannes de la série VXI à commande indirecte sont particulièrement appropriées pour contrôler l'eau, l'air, le gaz inerte, la vapeur d'eau et tous les fluides généralement non agressifs. Le corps en acier inoxydable est compact et permet une utilisation dans des espaces confinés. Plusieurs versions sont disponibles comme 2/2, 3/2 NF et NO et joints en NBR, Viton ou EPDM.

Le elettrovalvole della serie VXI a comando indiretto sono particolarmente indicate per il controllo di acqua, aria, gas inerti, vapore e in generale di fluidi non aggressivi. Il corpo in acciaio inossidabile estremamente compatto ne permettono l'utilizzo in spazi molto ristretti. Sono disponibili diverse versioni tra cui 2/2 e 3/2 NC e NA e guarnizioni in NBR, Viton e EPDM.

ORDERING CODE / CODIFICATION / CHIAVE DI CODIFICA

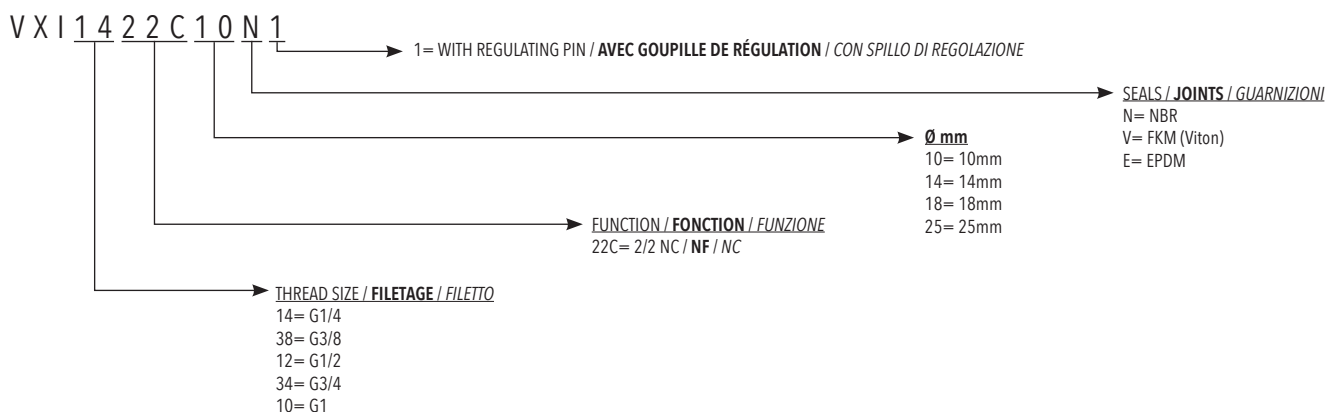

TECHNICAL CHARACTERISTICS / CARACTÉRISTIQUES TECHNIQUES / CARATTERISTICHE TECNICHE

Max. allowable pressure / Pression de service max. / <i>Pressione massima ammissibile</i>	25 bar		
Temperature range / Température d'utilisation / <i>Temperatura di utilizzo</i>	NBR	-10°C / +90°C	Air, inert gas, water max 75 °C, mineral oils, gas oil, fuel oils Air, gas neutres, eau max. 75°C, huiles minerales, diesel, mazout <i>Aria, gas inerti, acqua max 75 °C, oli minerali, gasolio, oli combustibili</i>
	FKM	-10°C / +140°C	Mineral oils, gasoline, gas oil, fuel oils Huiles minerales, essence, mazout <i>Oli minerali, benzina, oli combustibili</i>
	EPDM	-10°C / +140°C	Hot water, steam (max pressure 2.5 bar) Eau chaude, vapeur (Pression de service max 2.5bar) <i>Acqua calda, vapore (pressione max 2.5 bar)</i>

COMPONENTS / COMPOSANTS / COMPONENTI

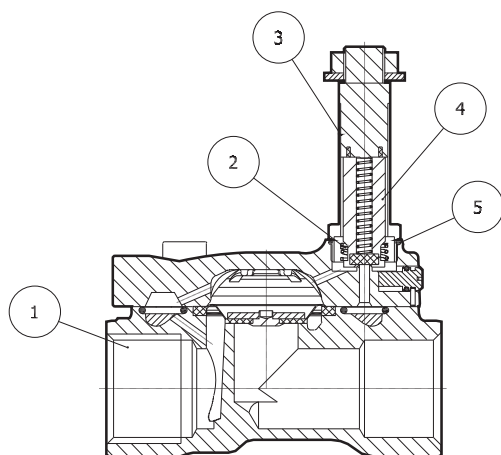

N.	DESCRIPTION / DESCRIPTION / <i>DESCRIZIONE</i>	MATERIAL / MATIÈRE / <i>MATERIALE</i>
1	Body / Corps / <i>Corpo</i>	Brass / Laiton / <i>Ottone</i>
2	Springs / Ressort / <i>Molle</i>	Stainless Steel / Acier inox / <i>Acciaio inox</i>
3	Armature tube / Tube de pilotage / <i>Tube guida</i>	Stainless Steel / Acier inox / <i>Acciaio inox</i>
4	Core / Noyau / <i>Nucleo</i>	Stainless Steel / Acier inox / <i>Acciaio inox</i>
5	Seals / Joint / <i>Guarnizioni</i>	NBR · EPDM · FKM

2/2 NC WITH MANUAL OVERRIDE / 2/2 NF AVEC COMMANDE MANUELLE / 2/2 NC CON COMANDO MANUALE

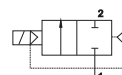

Code Code Codice	Seals Joints Guarnizioni	Thread size Filetage Filetto	Ø mm	Viscosity (Max cSt) Viscosité (Max cSt) Viscosità (Max cSt)	Kv m ³ /h	Power / Puissance Potenza		ΔP [bar]	
						DC (W)	AC (VA)	min	max
VXI1422C10N	NBR	1/4	10	25	1.88	6.5	-	0.15	11.2
VXI1422C10V	FKM					8	-	0.15	25
VXI1422C10E	EPDM					-	7.5	0.15	13.8
VXI3822C14N	NBR	3/8	14	25	3.32	6.5	-	0.15	11.2
VXI3822C14V	FKM					8	-	0.15	25
VXI3822C14E	EPDM					-	7.5	0.15	13.8
VXI1222C14N	NBR	1/2	14	25	3.53	6.5	-	0.15	11.2
VXI1222C14V	FKM					8	-	0.15	25
VXI1222C14E	EPDM					-	7.5	0.15	13.8
VXI3422C18N	NBR	3/4	18	25	5.56	6.5	-	0.15	11.2
VXI3422C18V	FKM					8	-	0.15	25
VXI3422C18E	EPDM					-	7.5	0.15	13.8
VXI1022C25N	NBR	1	25	25	10.97	6.5	-	0.15	11.2
VXI1022C25V	FKM					8	-	0.15	25
VXI1022C25E	EPDM					-	7.5	0.15	13.8
						-	11	0.15	25

Valves / Valves / Valvole

INDIRECT ACTING SOLENOID VALVES / ELECTROVANNES A COMMANDE INDIRECTE / ELETTROVALVOLE AD AZIONAMENTO INDIRETTO

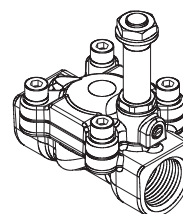
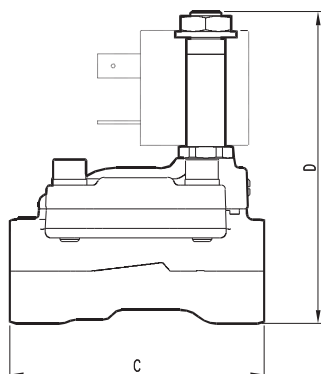
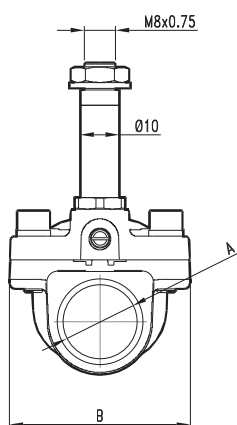

Size / Taille / Taglia	A	B	C	D
1/4"	G 1/4	35.2	55.5	72.5
3/8"	G 3/8	46.4	65.3	80.1
1/2"	G 1/2	46.4	65.3	80.1
3/4"	G 3/4	56.7	81	90.9
1"	G 1	65	95	97

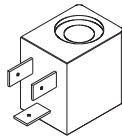
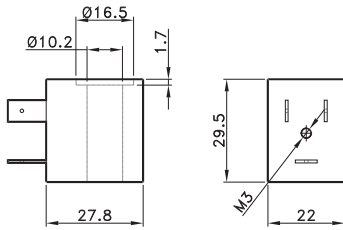

COILS 22 mm
BOBINE 22 mm
 BOBINE 22 mm

CODE	Power / Absorption / Assorbimento	
	Tension Tension Tensione	Power Puissance Potenza
B04051012	12 V DC	6,5 W
B04051024	24 V DC	6,5 W
B04052024	24 V AC	7,5 VA
B04052110	110 V AC	7,5 VA
B04052220	220 V AC	7,5 VA

TECHNICAL SPECIFICATIONS
CARACTERISTIQUES TECHNIQUES
 CARATTERISTICHE TECNICHE

Tension tolerance / Tolérance tension / Tolleranza di tensione	+10%
Protection with connector / Protection avec connecteur / Protezione con connettore	IP65
Max working temperature / Température max d'utilisation / Temperatura max di esercizio	+ 50°C
Duty cycle / Temps d'enclenchement / Inserimento	ED 100%

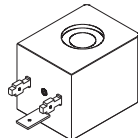
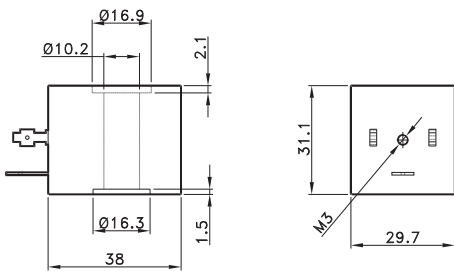

COILS 30 mm
BOBINE 30 mm
 BOBINE 30 mm

CODE	Power / Absorption / Assorbimento	
	Tension Tension Tensione	Power Puissance Potenza
B04061012	12 V DC	8 W
B04061024	24 V DC	8 W
B04062024	24 V AC	11 VA
B04062110	110 V AC	11 VA
B04062220	220 V AC	11 VA

TECHNICAL SPECIFICATIONS
CARACTERISTIQUES TECHNIQUES
 CARATTERISTICHE TECNICHE

Tension tolerance / Tolérance tension / Tolleranza di tensione	+10%
Protection with connector / Protection avec connecteur / Protezione con connettore	IP65
Max working temperature / Température max d'utilisation / Temperatura max di esercizio	+ 50°C
Duty cycle / Temps d'enclenchement / Inserimento	ED 100%

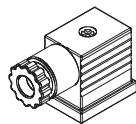
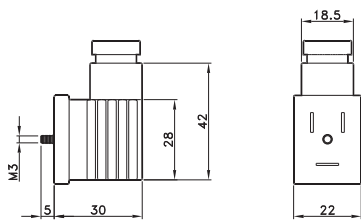

CONNECTORS 22 mm
CONNECTEUR 22 mm
 CONNETTORI 22 mm

CODE
AR40696

Cable diameter / **Diamètre du câble** / Diametro cavo
 6÷8 mm (22mm)
 8÷11mm (30mm)

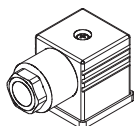
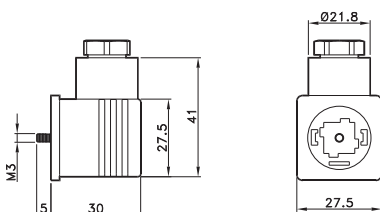

CONNECTORS 30 mm
CONNECTEUR 30 mm
 CONNETTORI 30 mm

CODE
VX0027

Cable diameter / **Diamètre du câble** / Diametro cavo
 6÷8 mm (22mm)
 8÷11mm (30mm)

FLUIDS / FLUIDES / FLUIDI	BODY MATERIAL / MATIERE DU CORPS MATERIALE CORPO		SEALS / JOINT / GUARNIZIONI		
	Brass / Laiton / Ottone	AISI316L	NBR	EPDM	FKM
Acetone / Acetone / Acetone	NO	OK	NO	OK	NO
Acetylene / Acétylène / Acetilene	OK	OK	NO	OK	OK
Argon	OK	OK	NO	OK	OK
Benzene / Benzène / Benzene	OK	OK	NO	NO	NO
Butane / Butano / Butane	OK	OK	NO	NO	OK
Carbon dioxide dry (gas) / dioxyde de carbone à sec (gas) / Anidride carbonica (gas)	OK	OK	OK	OK	OK
Carbon dioxide dry (liquid) / dioxyde de carbone à sec (liquide) / Anidride carbonica (liquida)	OK	OK	NO	NO	NO
Carbon disulfide / Disulfure de carbone / Solfuro di carbonio	OK	OK	NO	NO	NO
Chloroform (100%) / Chloroforme / Cloroformio	OK	OK	NO	NO	NO
Diesel fuel	OK	OK	OK	NO	OK
Helium / Hélium / Elio	OK	OK	OK	NO	OK
Ethane / Éthane / Etano	OK	OK	OK	NO	OK
Ethanol / Éthanol / Etanolo	OK	OK	NO	NO	NO
Ethyl acetate / Acétate d'éthyle / Acetato di etile	OK	OK	NO	NO	NO
Ethyl chloride / Chlorure d'éthyle / Cloruro di etile	OK	OK	OK	OK	OK
Ethylene glycol / Éthylène glycol / Glicole etilenico	OK	OK	OK	OK	OK
Formaldehyde (100%) / Formaldéhyde / Formaldeide	OK	OK	NO	OK	NO
Freon	OK	OK	NO	NO	NO
Glycerine / Glycérine / Glicerina	OK	OK	OK	OK	OK
Heptane / Heptane / Eptano	OK	OK	OK	NO	OK
Hexane / Hexane / Esano	OK	OK	OK	NO	OK
Hydrogen / Hydrogène / Idrogeno	OK	OK	OK	OK	OK
Hydrogen peroxide / Peroxyde d'hydrogène / Acqua Ossigenata	NO	OK	NO	NO	OK
Isobutane / Isobutane / Isobutano	OK	OK	OK	NO	OK
Isopentane / Isopentane / Isopentano	OK	OK	OK	NO	OK
Methane / Méthane / Metano	OK	OK	OK	NO	OK
Methanol / Méthanol / Metanolo	OK	OK	OK	OK	NO
Methyl chloride / Chlorométhane / Clorometano	OK	OK	NO	NO	OK
Mineral oil / Huile minérale / Olio minerale	OK	OK	OK	NO	OK
Neon	OK	OK	OK	NO	OK
Nitrobenzene / Nitrobenzène / Nitrobenzene	OK	OK	NO	NO	OK
Nitrogen / Azote / Azoto	OK	OK	OK	OK	OK
Oxygen / Oxygène / Ossigeno	OK	OK	NO	NO	OK
Pentane / Pentane / Pentano	OK	OK	OK	NO	OK
Petrol / Gasolina / Benzina	OK	OK	NO	NO	OK
Propane (LPG) / Propane (GPL) / Propano (GPL)	OK	OK	OK	NO	OK
Propyl Alcohol / Alcool Propylique / Alcool Propilico	OK	OK	OK	OK	OK
Toluene / Toluène / Toluene	OK	OK	NO	NO	OK
Trichlorethylene dry / Trichloréthylène / Trielina	NO	OK	NO	NO	OK
Vinegar / Vinaigre / Aceto	NO	OK	NO	OK	OK
Water demineralized / Eau purifiée / Acqua demineralizzata	OK	OK	OK	OK	OK
Water (Hard) / Eau dure / Acqua dura	OK	OK	OK	OK	OK
Water (Hot <75°C) / Eau chaude / Acqua calda	OK	OK	OK	OK	OK
Water (Hot and steam <140°C) / Vapeur et eau chaude <140° / Vapore e acqua calda <140°	OK	OK	NO	OK	NO
Water with glycol / Eau avec glycol / Acqua con glicole	OK	OK	OK	OK	OK
Xylene / Xylène / Xilene	OK	OK	NO	NO	OK