

Push-in fittings are so defined as they allow to connect the tube to the fitting in a "instantaneous" way without using tools. The tightness of the tube takes place through an elastic clamp which holds the tube on the external diameter and releases it by pushing the suitable puller.

This type of fittings is used in order to speed up the assembly phases mainly in reduced space and time-saving during connection of different pneumatic components.

**Le raccord rapide est appelé ainsi car il permet de raccorder instantanément le tuyau à la connexion c'est à dire sans l'aide d'outils.**

**L'étanchéité du tube a lieu au moyen d'une bague laiton élastique qui maintient le tuyau flexible sur le diamètre extérieur et en actionnant cette bague le tuyau se déconnecte. Ce système est utilisé pour simplifier les étapes de montage. Idéal pour les espaces réduits ce raccord permet de gagner du temps dans la connexion des composants pneumatiques.**

*I raccordi rapidi sono così denominati perché permettono di accoppiare il tubo al raccordo in modo istantaneo senza l'ausilio di utensili.*

*La tenuta del tubo avviene per mezzo di una pinza elastica che trattiene il tubo sul diametro esterno e lo rilascia spingendo l'apposito estrattore. Questa tipologia di raccordi viene utilizzata per snellire le fasi di montaggio spesso in spazi ridotti e risparmiare tempo nei collegamenti dei vari componenti pneumatici.*



#### ORDERING CODE / CODIFICATION / CHIAVE DI CODIFICA

A 1 0 0 6 1/8

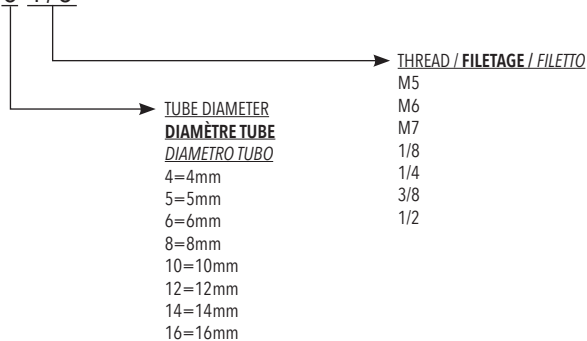

#### TECHNICAL DATA / DONNÉES TECHNIQUES / DATI TECNICI

Fluid / <b>Fluide</b> / <i>Fluido</i>	Air / <b>Air</b> / <i>Aria</i>
Operating temperature range / <b>Température d'utilisation</b> / <i>Temperatura di esercizio</i>	-20°C / +80°C
Max operating pressure / <b>Pression Max</b> / <i>Pressione massima di esercizio</i>	16 bar
Vacuum / <b>Vide</b> / <i>Vuoto</i>	max 98%
Body material / <b>Matière corps</b> / <i>Materiale corpo</i>	Nickel-plated brass / <b>Laiton nickelé</b> / <i>Ottone nichelato</i>
Gripper clamp / <b>Pince d'accrochage</b> / <i>Pinza di aggancio</i>	AlSi 316L
Ring / <b>Ring</b> / <i>Anello</i>	Nickel-plated brass / <b>Laiton nickelé</b> / <i>Ottone nichelato</i>
Seals / <b>Joints</b> / <i>Guarnizioni</i>	NBR
Threads / <b>Filetage</b> / <i>Filettature</i>	Parallel DIN EN ISO 228 / <b>Cylindrique DIN EN ISO 228</b> / <i>Cilindrico DIN EN ISO 228</i> Taper DIN EN 10226 (DIN 2999) / <b>Conique DIN EN 10226 (DIN 2999)</b> / <i>Conico DIN EN 10226 (DIN 2999)</i> Metric DIN ISO 261 / <b>Métrique DIN ISO 261</b> / <i>Metrico DIN ISO 261</i>
Recommended tubes / <b>Tubes recommandés</b> / <i>Tubi raccomandati</i>	Polyamide (PA) / <b>Polyamide (PA)</b> / <i>Poliammide (PA)</i> Polyurethane (PU) / <b>Polyuréthane (PU)</b> / <i>Poliuretano (PU)</i> Polyethylene (PE) / <b>Polyéthylène (PE)</b> / <i>Polietilene (PE)</i>
Tube tolerances / <b>Tolérance du tube</b> / <i>Tolleranza Tubi</i>	PE, PU Tube +/- 0.1 mm / <b>Tube PE, PU +/- 0,1 mm</b> / <i>Tube PE, PU +/- 0.1 mm</i>
Recommended torque values / <b>Valeurs de couple recommandées</b> / <i>Valori di coppia consigliati</i>	(M5=1Nm)(G1/8=3-5Nm)(G1/4=5-8Nm)(G3/8=8-13Nm)

#### THE KEY POINTS / LES POINTS CLES / I PUNTI DI FORZA

Indestructible product even it is used for hooking and unhooking for a long time.

It allows to better support the tube when it has to be installed in very little spaces and/or with really tight bends.

**Produit résistant, même s' il est plusieurs fois encliqueté ou inversément. Il est idéal en cas d'utilisation dans des espaces réduits et lorsque le tube est soumis à des rayons de courbure très étroits.**

*Prodotto indistruttibile anche se viene utilizzato per aggancio e sgancio prolungati.*

*Permette l'utilizzo in piccoli spazi e/o per curve del tubo particolarmente strette.*



The special shape of the clamp allows to "drive" the tube along the fitting to obtain a perfect sealing with the inside o-ring.  
**La forme spéciale de la bague permet d'orienter le tube le long du raccord pour obtenir une parfaite étanchéité grâce au joint torique à l'intérieur.**

*La particolare forma della pinza permette di guidare il tubo lungo il raccordo per ottenere una perfetta tenuta con l'anello di tenuta interno.*

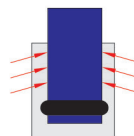
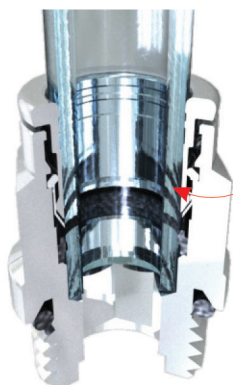

**A101**

STRAIGHT MALE ADAPTOR PARALLEL / **DROIT MÂLE CYLINDRIQUE** / DIRITTO MASCHIO CILINDRICO

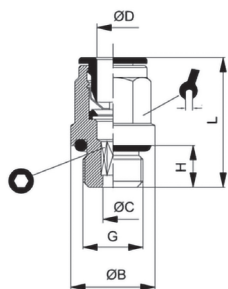

CODE	ØD	G	ØB	ØC	H	L		○	min.pcs.
A101 3-M3	3	M3	5,5	1,5	3	13,5	6,5	1,5	10
A101 3-M5	3	M5	8	2,1	4	15	6,5	2	10
A101 4-M5	4	M5	8	2,5	4	20,5	9	2,5	10
A101 4-M6	4	M6	9	2,6	7	23,5	9	2,5	10
A101 4-M7	4	M7	10,5	3	6	22,5	9	3	10
A101 4-M8	4	M8	12	2,6	7	24,5	10	2,5	10
A101 4-1/8	4	G1/8	13,5	2,6	5,5	19,5	9	2,5	10
A101 4-1/4	4	G1/4	17	2,6	6,5	19,5	9	2,5	10
A101 5-M5	5	M5	8	2,6	4	22	9,5	2,5	10
A101 5-1/8	5	G1/8	13,5	4,2	5,5	22	10	4	10
A101 5-1/4	5	G1/4	17	4,2	6,5	22	10	4	10
A101 6-M5	6	M5	8	2,5	4	22,5	11	2,5	10
A101 6-M6	6	M6	9	2,6	5	23,5	11	2,5	10
A101 6-M7	6	M7	11	3,6	6	24,5	11	3,5	10
A101 6-1/8	6	G1/8	13,5	4,2	5,5	23,5	11	4	10
A101 6-1/4	6	G1/4	17	4,2	6,5	22,5	11	4	10
A101 6-3/8	6	G3/8	20	4,2	9	25	13	4	10
A101 8-1/8	8	G1/8	12,8	5,2	5,5	26,5	13	5	10
A101 8-1/4	8	G1/4	17	6,2	6,5	23,5	13	6	10
A101 8-3/8	8	G3/8	20	6,2	9	25	13	6	10
A101 8-1/2	8	G1/2	23	6,2	11	31,5	13	6	10
A101 10-1/8	10	G1/8	13,5	5,2	5,5	29	16	5	10
A101 10-1/4	10	G1/4	16	7,3	6,5	27,5	16	7	10
A101 10-3/8	10	G3/8	21	8,3	9	29,5	16	8	10
A101 10-1/2	10	G1/2	24	8,3	11	31	16	8	10
A101 12-1/4	12	G1/4	16	7,3	6,5	30	18	7	10
A101 12-3/8	12	G3/8	21	10,3	9	31	18	10	10
A101 12-1/2	12	G1/2	24	10,3	11	31,5	18	10	10
A101 14-3/8	14	G3/8	21	10,3	9	34,5	21	10	10
A101 14-1/2	14	G1/2	25	12,3	11	34,5	21	12	10

**A190**

STRAIGHT MALE ADAPTOR TAPER / **DROIT MÂLE CONIQUE** / DIRITTO MASCHIO CONICO

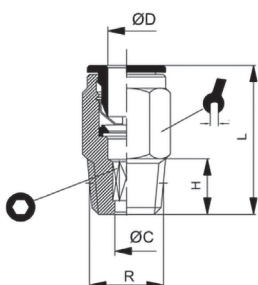

CODE	ØD	R	ØC	H	L		○	min.pcs.
A190 4-1/8	4	R1/8	2,6	8	22,5	10	2,5	10
A190 4-1/4	4	R1/4	2,6	11	22,5	14	2,5	10
A190 6-1/8	6	R1/8	4,2	7	24,5	11	4	10
A190 6-1/4	6	R1/4	4,2	11	24,5	14	4	10
A190 8-1/8	8	R1/8	5,2	7	27,5	13	5	10
A190 8-1/4	8	R1/4	5,2	11	26,5	13	5	10
A190 8-3/8	8	R3/8	5,2	11,5	27,5	13	5	10
A190 10-1/4	10	R1/4	7,3	11	32,5	16	7	10
A190 10-3/8	10	R3/8	8,3	11,5	32,5	17	8	10

**A102**

STRAIGHT FEMALE ADAPTOR / **DROIT FEMELLE** / DIRITTO FEMMINA

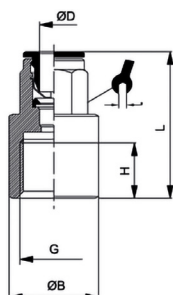

CODE	ØD	G	ØB	H	L		min.pcs.
A102 4-M5	4	M5	9	5	22,5	9	10
A102 4-1/8	4	G1/8	12	6,5	26,5	9	10
A102 4-1/4	4	G1/4	17	10	29,5	9	10
A102 5-1/8	5	G1/8	12	6,5	27	10	10
A102 5-1/4	5	G1/4	16	10	30	10	10
A102 6-1/8	6	G1/8	12	6,5	27	11	10
A102 6-1/4	6	G1/4	17	10	31	11	10
A102 8-1/8	8	G1/8	12	6,5	28	13	10
A102 8-1/4	8	G1/4	17	10	32	13	10
A102 10-1/4	10	G1/4	16	10	32	16	10
A102 10-3/8	10	G3/8	20	13	37,5	20	10

**A103**

STRAIGHT CONNECTOR / DROIT DOUBLE / DIRITTO INTERMEDIO

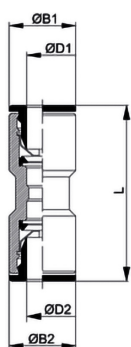

CODE	ØD1	ØD2	ØB1	ØB2	L	min.pcs.
A103 3	3	3	6,5	6,5	21	10
A103 4	4	4	9	9	31	10
A103 5	5	5	9,5	9,5	33	10
A103 6	6	6	11	11	34	10
A103 8	8	8	13	13	38	10
A103 10	10	10	15	15	39	10
A103 12	12	12	17	17	43,5	10
A103 14	14	14	20	20	48	10
Reduced / Réduit / Riduzione						
A103 6-4	6	4	11	9	34	10
A103 8-6	8	6	13	11	39	10
A103 10-8	10	8	15	13	40	10
A103 12-10	12	10	17	15	42,5	10
A103 14-12	14	12	20	17	45,5	10

**A104**

ELBOW CONNECTOR / ÉQUERRE / GOMITO INTERMEDIO

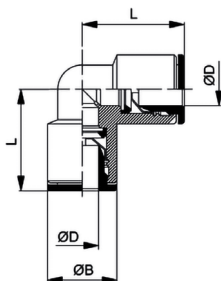

CODE	ØD	ØB	L	min.pcs.
A104 3	3	6	12	10
A104 4	4	9	17,5	10
A104 5	5	9,5	19	10
A104 6	6	11	20	10
A104 8	8	13	23	10
A104 10	10	15	25	10
A104 12	12	17	27,5	10
A104 14	14	20	31	10

**A105**

TEE CONNECTOR / CONNEXION T / INTERMEDIO AT

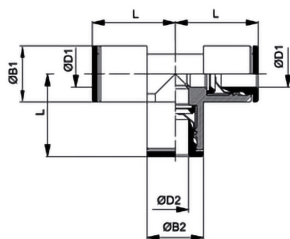

CODE	ØD1	ØD2	ØB1	ØB2	L	min.pcs.
A105 3	3	3	6,5	6,5	11,5	10
A105 4	4	4	9	9	18	10
A105 5	5	5	9,5	9,5	19	10
A105 6	6	6	11	11	19,5	10
A105 8	8	8	13	13	22,5	10
A105 10	10	10	15	15	25	10
A105 12	12	12	17	17	27	10
A105 14	14	14	20	20	31	10
Reduced / Réduit / Riduzione						
A105 6-4-6	6	4	11	9	19,5	10
A105 8-6-8	8	6	13	11	22,5	10
A105 10-8-10	10	8	15	13	25	10

**A199**

SINGLE BANJO BODY / BANJO SIMPLE / ANELLO SEMPLICE

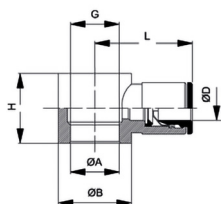

CODE	ØD	G	ØA	ØB	H	L	min.pcs.
A199 4-M5	4	M5	5	9	9	18,5	10
A199 4-M6	4	M6	6	9	9	19,5	10
A199 4-1/8	4	G1/8	9,9	14	15	21	10
A199 5-M5	5	M5	5	9	9	19	10
A199 5-1/8	5	G1/8	9,9	14	15	22,5	10
A199 6-M5	6	M5	5,1	9	10,5	19,5	10
A199 6-1/8	6	G1/8	9,9	14	15	23	10
A199 6-1/4	6	G1/4	13,3	18	17	24	10
A199 8-1/8	8	G1/8	9,9	14	15	24,5	10
A199 8-1/4	8	G1/4	13,3	18	17	26	10
A199 8-3/8	8	G3/8	16,6	21	20	27,5	10
A199 10-1/4	10	G1/4	13,3	18	17	27	10
A199 10-3/8	10	G3/8	16,7	21	20	28,5	10
A199 12-1/4	12	G1/4	13,3	18	17	28,5	10
A199 12-3/8	12	G3/8	16,7	21	20	29,5	10

**A109**

DOUBLE BANJO BODY / BANJO DOUBLE / ANELLO DOPPIO

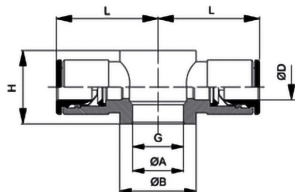

CODE	ØD	G	ØA	ØB	H	L	min.pcs.
A109 4-M5	4	M5	5	7	9	18,5	10
A109 4-1/8	4	G1/8	9,9	14	15	21	10
A109 5-M5	5	M5	5	9	9,5	19	10
A109 5-1/8	5	G1/8	9,9	14	15	22,5	10
A109 6-1/8	6	G1/8	9,9	14	15	23	10
A109 6-1/4	6	G1/4	13,3	18	17	24	10
A109 8-1/8	8	G1/8	9,9	14	15	24,5	10
A109 8-1/4	8	G1/4	13,3	18	17	26	10

**A114**

COMPLETE SINGLE BANJO BODY ROTATING / COUDE BANJO SIMPLE + VIS / ASTA CILINDRICO CON ANELLO

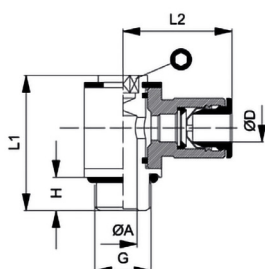

CODE	ØD	G	ØA	H	L1	L2	Ø	min.pcs.
A114 3-M3	3	M3	1,5	3	16	14	2	10
A114 3-M5	3	M5	2	4	16,8	14	2	10
A114 4-M5	4	M5	2	4	16,8	18,5	2	10
A114 4-1/8	4	G1/8	5,5	5,5	24,5	21,1	3	10
A114 5-M5	5	M5	2	4	16,8	19,5	2	10
A114 5-1/8	5	G1/8	5,5	5,5	24,5	22,5	3	10
A114 6-1/8	6	G1/8	5,5	5,5	24,5	23	3	10
A114 6-1/4	6	G1/4	7,8	8	29,3	24,2	4	10
A114 8-1/8	8	G1/8	5,5	5,5	24,5	24,5	3	10
A114 8-1/4	8	G1/4	7,8	8	29,3	26	4	10
A114 8-3/8	8	G3/8	10	9	34	27,5	5	10
A114 10-1/4	10	G1/4	7,8	8	29,3	27	4	10
A114 10-3/8	10	G3/8	10	9	34	28,5	5	10
A114 12-1/4	12	G1/4	7,8	8	29,3	28,5	4	10
A114 12-3/8	12	G3/8	10	9	34	29	5	10

**A115**

COMPLETE DOUBLE BANJO BODY / COUDE BANJO DOUBLE + VIS / ASTA CILINDRICA CON ANELLO DOPPIO

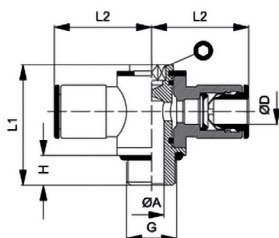

CODE	ØD	G	ØA	H	L1	L2	Ø	min.pcs.
A115 4-M5	4	M5	2	4	16,8	18,5	2	10
A115 4-1/8	4	G1/8	5,5	5,5	24,5	21,1	3	10
A115 5-M5	5	M5	2	4	16,8	19,5	2	10
A115 5-1/8	5	G1/8	5,5	5,5	24,5	22,5	3	10
A115 6-1/8	6	G1/8	5,5	5,5	24,5	23	3	10
A115 6-1/4	6	G1/4	7,8	8	29,3	24,2	4	10
A115 8-1/8	8	G1/8	5,5	5,5	24,5	24,3	3	10
A115 8-1/4	8	G1/4	7,8	8	29,3	26	4	10
A115 8-3/8	8	G3/8	10	9	34	27,5	5	10
A115 10-1/4	10	G1/4	7,8	8	29,3	27	4	10
A115 10-3/8	10	G3/8	10	9	34	28,5	5	10
A115 12-3/8	12	G3/8	10	9	34	29,5	5	10

**A110**

COMPLETE SINGLE SWIVEL BANJO / COUDE BANJO SIMPLE CYL.OR / ORIENTABILE SEMPLICE CON VITE CILINDRICA

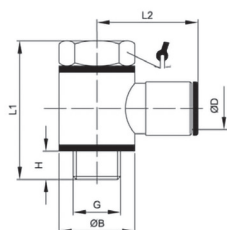

CODE	ØD	G	ØB	H	L1	L2	Ø	min.pcs.
A110 4-M5	4	M5	9	3	17,5	18,5	8	10
A110 4-M6	4	M6	9	7	22	19,5	9	10
A110 4-1/8	4	G1/8	14	5,5	28	21	14	10
A110 5-M5	5	M5	9	3	17,5	19,5	9	10
A110 5-1/8	5	G1/8	14	5,5	28	22,5	14	10
A110 6-M5	6	M5	9	3	19,5	19,5	8	10
A110 6-1/8	6	G1/8	14	5,5	28	23	14	10
A110 6-1/4	6	G1/4	18	7	33	24	17	10
A110 8-1/8	8	G1/8	14	5,5	28	24,5	14	10
A110 8-1/4	8	G1/4	18	7	33	26	17	10
A110 8-3/8	8	G3/8	21	7,5	36	27,5	19	10
A110 10-1/4	10	G1/4	18	7	33	27	17	10
A110 10-3/8	10	G3/8	21	7,5	36	28,5	19	10
A110 12-1/4	12	G1/4	18	7	33	28,5	17	10
A110 12-3/8	12	G3/8	21	7,5	36	29,5	19	10

**A112**

COMPLETE DOUBLE SWIVEL BANJO / **BANJO DOUBLE AVEC VIS CYLINDRIQUE /**  
**ORIENTABILE DOPPIO CON VITE CILINDRICA**

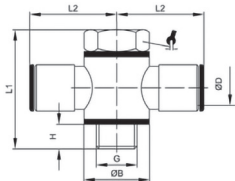

CODE	ØD	G	ØB	H	L1	L2		min.pcs.
A112 4-M5	4	M5	7	3	17,5	18,5	8	10
A112 4-1/8	4	G1/8	14	5,5	28	21	14	10
A112 5-M5	5	M5	7	3	17,5	19,5	8	10
A112 5-1/8	5	G1/8	14	5,5	28	22,5	14	10
A112 6-1/8	6	G1/8	14	5,5	28	23	14	10
A112 6-1/4	6	G1/4	18	7	33	24	17	10
A112 8-1/8	8	G1/8	14	5,5	28	24,5	14	10
A112 8-1/4	8	G1/4	18	7	33	26	17	10
A112 8-3/8	8	G3/8	21	7,5	36	27,5	19	10
A112 10-1/4	10	G1/4	18	7	33	27	17	10
A112 10-3/8	10	G3/8	21	7,5	36	28,5	19	10
A112 12-3/8	12	G3/8	21	7,5	36	29,5	19	10

**A113**

COMPLETE SINGLE BANJO, DOUBLE / **DOUBLE COUDE BANJO CYL. / ASTA CILINDRICA CON DOPPIO ANELLO**

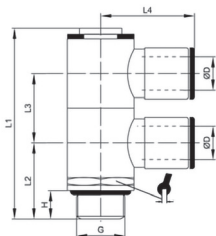

CODE	ØD	G	H	L1	L2	L3	L4		min.pcs.
A113 4-1/8	4	G1/8	6	44	19	15	21	14	10
A113 6-1/8	6	G1/8	6	44	19	15	23	14	10
A113 6-1/4	6	G1/4	8	50	22,5	17	24	17	10
A113 8-1/8	8	G1/8	6	44	19	15	24,5	14	10
A113 8-1/4	8	G1/4	8	50	22,5	17	26	17	10
A113 10-1/4	10	G1/4	8	50	22,5	17	27	17	10
A113 12-1/4	12	G1/4	8	50	22,5	17	29	17	10

**A116**

COMPLETE SINGLE BANJO, TRIPLE / **TRIPLE COUDE BANJO CYL. / ASTA CILINDRICA CON TRIPLO ANELLO**

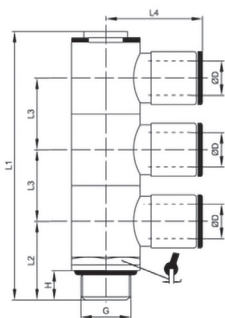

CODE	ØD	G	H	L1	L2	L3	L4		min.pcs.
A116 4-1/8	4	G1/8	6	59	19	15	21	14	10
A116 6-1/8	6	G1/8	6	59	19	15	23	14	10
A116 6-1/4	6	G1/4	8	67	22	17	24	17	10
A116 8-1/8	8	G1/8	6	59	19	15	24,5	14	10
A116 8-1/4	8	G1/4	8	67	22	17	26	17	10
A116 10-1/4	10	G1/4	8	67	22	17	27	17	10
A116 12-1/4	12	G1/4	8	67	22	17	28,5	17	10

**A111**

BULKHEAD UNION / **TRAVERSÉE DE CLOISON / PASSAPARETE**

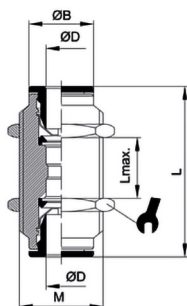

CODE	ØD	M	ØB	Lmax	L		min.pcs.
A111 4	4	M10x1	9	15	32	13	10
A111 5	5	M11x1	9,5	14	33	14	10
A111 6	6	M14x1	11	11	33,5	17	10
A111 8	8	M16x1	13	16	37	18	10
A111 10	10	M17x1	15	19	39,5	20	10
A111 12	12	M20x1	17	17	42	24	10
A111 14	14	M22x1	20	21	46,5	25	10



**A117**



BULKHEAD UNION ELBOW / ÉQUERRE TRAVERSÉE DE CLOISON / GOMITO PASSAPARETE

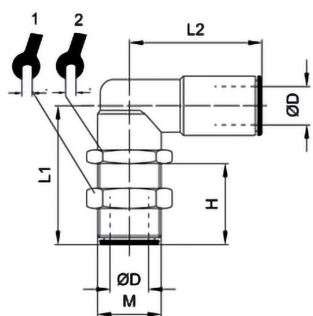

CODE	ØD	M	H	L1	L2	1	2	min.pcs.
A117 4	4	M10x1	13	26	20	13	13	10
A117 6	6	M14x1	15	28	21,5	17	17	10
A117 8	8	M16x1	17,5	30,5	24	18	18	10
A117 10	10	M17x1	19,5	35	27	20	20	10

**A122**



MANOMETER BULKHEAD CONNECTOR / TRAVERSÉE DE CLOISON FEMELLE / PASSAPARETE FEMMINA

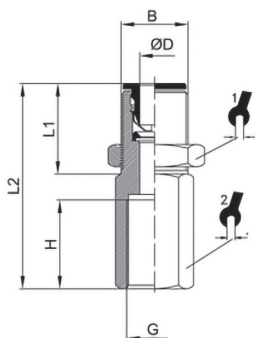

CODE	ØD	G	B	H	L1	L2	1	2	min.pcs.
A122 4-1/8	4	G1/8	M10x1	6,5	15	25	13	15	10
A122 6-1/8	6	G1/8	M14x1	6,5	15,5	26,5	17	17	10
A122 6-1/4	6	G1/4	M14x1	10	15,5	31	17	17	10
A122 8-1/8	8	G1/8	M16x1	6,5	15,5	28,5	19	17	10
A122 8-1/4	8	G1/4	M16x1	10	15,5	33	19	17	10

**A118**



THREADED ELBOW ADAPTOR TAPER / ÉQUERRE MALE CONIQUE FIXE / GOMITO MASCHIO CONICO FISSO

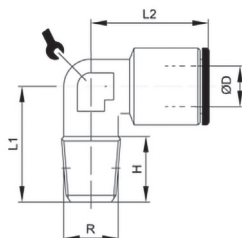

CODE	ØD1	R	H	L1	L2	1	min.pcs.
A118 4-1/8	4	R1/8	8	16,5	18,5	10	10
A118 5-1/8	5	R1/8	8	16,5	19	10	10
A118 6-1/8	6	R1/8	8	16,5	22,5	10	10
A118 6-1/4	6	R1/4	11,5	22,5	24	12	10
A118 8-1/8	8	R1/8	10	18,5	25	11	10
A118 8-1/4	8	R1/4	12	22,5	25	11	10
A118 10-1/4	10	R1/4	12	22	25	14	10

**A121**

ROTARY ELBOW MALE ADAPTOR / ÉQUERRE MALE CYLINDRIQUE / GOMITO MASCHIO GIREVOLE CILINDRICO

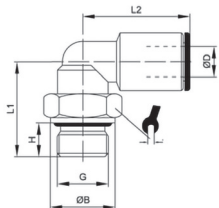

CODE	ØD	G	ØB	H	L1	L2		min.pcs.
A121 4-M5	4	M5	8	4	14,5	18	9	10
A121 4-M6	4	M6	9	5	16	18	9	10
A121 4-M7	4	M7	10	6	17	18	9	10
A121 4-1/8	4	G1/8	13	5,5	19,5	20	13	10
A121 4-1/4	4	G1/4	16	6,5	22,5	20	13	10
A121 5-M5	5	M5	8	4	14,5	20,5	9	10
A121 5-1/8	5	G1/8	13	5,5	19,5	21	13	10
A121 5-1/4	5	G1/4	16	6,5	22,5	21	13	10
A121 6-M5	6	M5	8	4	15	21	9	10
A121 6-M6	6	M6	9	5	16	21	9	10
A121 6-M7	6	M7	10	6	17	21	9	10
A121 6-M12x1,25	6	M12x1,25	16	8	24	21,5	13	10
A121 6-M12x1,5	6	M12x1,5	16	8	24	21,5	13	10
A121 6-1/8	6	G1/8	13	5,5	19,5	21,5	13	10
A121 6-1/4	6	G1/4	16	6,5	22,5	21,5	13	10
A121 8-1/8	8	G1/8	13	5,5	20	23,5	13	10
A121 8-1/4	8	G1/4	16	6,5	23	23,5	13	10
A121 8-3/8	8	G3/8	20	9	26	23,5	13	10
A121 10-1/4	10	G1/4	16	6,5	23	26,5	16	10
A121 10-3/8	10	G3/8	20	9	28	26,5	16	10
A121 10-1/2	10	G1/2	25	11	30	26,5	16	10
A121 12-1/4	12	G1/4	16	6,5	29	29	16	10
A121 12-3/8	12	G3/8	20	9	28,5	29	20	10
A121 12-1/2	12	G1/2	25	11	33,5	29	20	10
A121 14-3/8	14	G3/8	20	9	28,5	32	20	10
A121 14-1/2	14	G1/2	25	11	33,5	32	20	10

**A191**

ROTARY ELBOW MALE ADAPTOR TAPER / ÉQUERRE MALE CONIQUE / GOMITO MASCHIO GIREVOLE CONICO

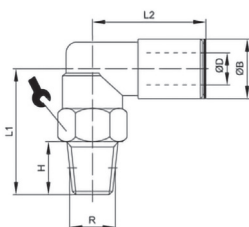

CODE	ØD	R	H	L1	L2		min.pcs.
A191 4-1/8	4	R1/8	7	20	20	13	10
A191 4-1/4	4	R1/4	11	25	20	14	10
A191 6-1/8	6	R1/8	7	20	21,5	13	10
A191 6-1/4	6	R1/4	11	25	21,5	14	10
A191 8-1/8	8	R1/8	7	20,5	24	13	10
A191 8-1/4	8	R1/4	11	25,5	24	14	10
A191 8-3/8	8	R3/8	11	28,5	24	18	10
A191 10-1/4	10	R1/4	11	26	27	16	10
A191 10-3/8	10	R3/8	11	30	27	18	10
A191 12-3/8	12	R3/8	11	32,5	29	20	10
A191 12-1/2	12	R1/2	14	35,5	29	22	10
A191 14-3/8	14	R3/8	11	35,5	32	22	10
A191 14-1/2	14	R1/2	14	35,5	32	22	10

**A123**

ROTARY ELBOW FEMALE / ÉQUERRE FEMELLE / GOMITO FEMMINA GIREVOLE

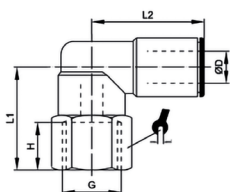

CODE	ØD	G	H	L1	L2		min.pcs.
A123 4-1/8	4	G1/8	8	18	20	13	10
A123 4-1/4	4	G1/4	11	22	20	16	10
A123 6-1/8	6	G1/8	8	18	21,5	13	10
A123 6-1/4	6	G1/4	11	22	21,5	16	10
A123 8-1/8	8	G1/8	8	18,5	23,5	13	10
A123 8-1/4	8	G1/4	11	22,5	23,5	16	10
A123 10-1/4	10	G1/4	9	24	26,5	16	10

**A192**

ROTARY ELBOW MALE LONG ADAPTOR / ÉQUERRE LONGUE MALE CYLINDRIQUE /  
 GOMITO MASCHIO LUNGO GIREVOLE CILINDRICO

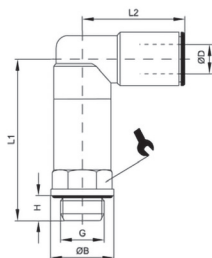

CODE	ØD	G	ØB	H	L1	L2		min.pcs.
A192 4-M5	4	M5	8	4	24	18	9	10
A192 4-1/8	4	G1/8	13	5,5	32,5	20	13	10
A192 4-1/4	4	G1/4	16	6,5	36,5	20	13	10
A192 6-M5	6	M5	8	4	24	21	9	10
A192 6-1/8	6	G1/8	13	6	33	21,5	13	10
A192 6-1/4	6	G1/4	16	6,5	36,5	21,5	13	10
A192 8-1/8	8	G1/8	13	6	33	23,5	13	10
A192 8-1/4	8	G1/4	16	6,5	37	23,5	13	10
A192 8-3/8	8	G3/8	20	7	34,5	21	20	10
A192 10-1/4	10	G1/4	16	6,5	37	26,5	16	10
A192 10-3/8	10	G3/8	20	7	38	26,5	20	10

**A119**

ROTARY TEE ADAPTOR PARALLEL / T MALE CYLINDRIQUE / T MASCHIO GIREVOLE CILINDRICO

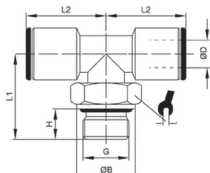

CODE	ØD	G	ØB	H	L1	L2		min.pcs.
A119 4-M5	4	M5	8	4	16,6	19	9	10
A119 4-1/8	4	G1/8	13	6	20	20	13	10
A119 4-1/4	4	G1/4	16	6,5	22,5	20	13	10
A119 6-1/8	6	G1/8	13	6	20	21,5	13	10
A119 6-1/4	6	G1/4	16	6,5	22,5	21,5	13	10
A119 8-1/8	8	G1/8	13	6	20	23,5	13	10
A119 8-1/4	8	G1/4	16	6,5	22,5	23,5	13	10
A119 8-3/8	8	G3/8	20	9	22,5	23,5	13	10
A119 10-1/4	10	G1/4	16	6,5	23	26,5	16	10
A119 10-3/8	10	G3/8	20	9	28	26,5	16	10
A119 12-1/4	12	G1/4	16	8	30,5	29	16	10
A119 12-3/8	12	G3/8	20	9	28,5	29	20	10
A119 14-1/2	14	G1/2	25	11	33,5	32	20	10

**A124**

ROTARY TEE ADAPTOR FEMALE PARALLEL / T FEMELLE CYLINDRIQUE / T FEMMINA GIREVOLE CILINDRICA

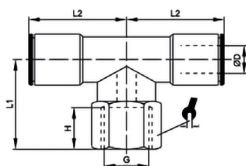

CODE	ØD	G	H	L1	L2		min.pcs.
A124 4-1/8	4	G1/8	8	18	20	13	10
A124 4-1/4	4	G1/4	11	22	20	16	10
A124 6-1/8	6	G1/8	8	18	21,5	13	10
A124 6-1/4	6	G1/4	11	22	21,5	16	10
A124 8-1/8	8	G1/8	8	18	23,5	13	10
A124 8-1/4	8	G1/4	11	22	23,5	16	10
A124 10-1/4	10	G1/4	11	24	26,5	16	10

**A120**

LATERAL MALE TEE SWIVEL PARALLEL / T MALE CYLINDRIQUE LATERAL / T MASCHIO LATERALE GIREVOLE CILINDRICO

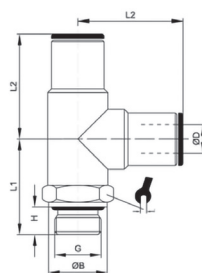

CODE	ØD	G	ØB	H	L1	L2		min.pcs.
A120 4-M5	4	M5	8	4	16,5	19	9	10
A120 4-1/8	4	G1/8	13	5,5	19,5	20,5	13	10
A120 4-1/4	4	G1/4	16	6,5	22,5	20,5	13	10
A120 6-1/8	6	G1/8	13	6	19,5	21,5	13	10
A120 6-1/4	6	G1/4	16	6,5	22,5	21,5	13	10
A120 8-1/8	8	G1/8	13	6	19,5	23,5	13	10
A120 8-1/4	8	G1/4	16	6,5	22,5	23,5	13	10
A120 8-3/8	8	G3/8	20	9	25,5	23,5	13	10
A120 10-1/4	10	G1/4	16	6,5	23	26,5	16	10
A120 10-3/8	10	G3/8	20	9	28	27	16	10
A120 12-1/4	12	G1/4	16	8	23	29	16	10
A120 12-3/8	12	G3/8	20	9	28	29	16	10
A120 12-1/2	12	G1/2	25	11	30	28,5	20	10
A120 14-3/8	14	G3/8	20	9	28,5	32	20	10
A120 14-1/2	14	G1/2	25	11	33	33	20	10



**A107**

ADAPTOR SHORT PARALLEL / ADAPTATEUR CYLINDRIQUE / ADATTATORE CILINDRICO

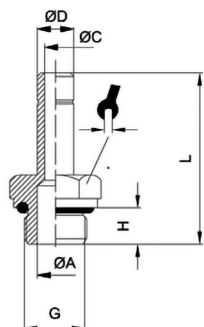

CODE	ØD	G	ØC	ØA	H	L		min.pcs.
A107 4-M5	4	M5	2	2	4	25	8	10
A107 4-1/8	4	G1/8	2	6	5,5	28	13	10
A107 4-1/4	4	G1/4	2	7,5	8	30	13	10
A107 5-M5	5	M5	2,6	2,6	4	25	8	10
A107 5-1/8	5	G1/8	3	6	6	28,5	13	10
A107 5-1/4	5	G1/4	3	7,5	8	31	13	10
A107 6-M5	6	M5	2,6	2,6	4	26	8	10
A107 6-1/8	6	G1/8	4	6	5,5	29	13	10
A107 6-1/4	6	G1/4	4	7,5	6,5	30,5	13	10
A107 8-1/8	8	G1/8	6	6	5,5	30,5	13	10
A107 8-1/4	8	G1/4	6	7,5	6,5	32	13	10
A107 8-3/8	8	G3/8	6	9	9	35,5	13	10
A107 10-1/8	10	G1/8	6	6	6	35,5	13	10
A107 10-1/4	10	G1/4	8	8	8	38	13	10
A107 10-3/8	10	G3/8	8	11	9	41	13	10
A107 12-1/4	12	G1/4	8	8	8	39	13	10
A107 12-3/8	12	G3/8	10	11	9	42	13	10
A107 12-1/2	12	G1/2	10	13	11	44	16	10
A107 14-3/8	14	G3/8	12	12	9	44,5	16	10
A107 14-1/2	14	G1/2	12	13	11	46,5	16	10

**A125**

ADAPTOR LONG PARALLEL / ADAPTATEUR PROLONGE CYLINDRIQUE / ADATTATORE CILINDRICO PROLUNGATO

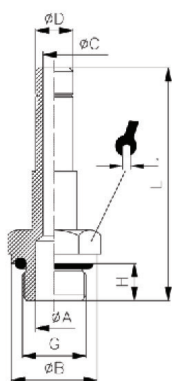

CODE	ØD	G	ØC	ØB	H	L		min.pcs.
A125 4-M7	4	M7	2,0	-	6	38,0	10	10
A125 4-1/8	4	G1/8	2,0	13,0	6	39,2	13	10
A125 6-M7	6	M7	4,0	-	6	42,0	10	10
A125 6-1/8	6	G1/8	4,0	13,0	6	43,5	13	10
A125 6-1/4	6	G1/4	4,0	16,0	8	46,0	13	10
A125 8-1/8	8	G1/8	6,0	13,0	6	46,7	13	10
A125 8-1/4	8	G1/4	6,0	16,0	8	49,7	13	10
A125 10-1/4	10	G1/4	8,0	16,0	8	55,5	13	10

**A106**

DOUBLE CONNECTOR / CONNECTEUR DOUBLE / CODOLO

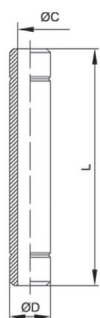

CODE	ØD	ØC	L	min.pcs.
A106 4	4	2	35	10
A106 5	5	3	33	10
A106 6	6	4	36,5	10
A106 8	8	6	40	10
A106 10	10	8	45,5	10
A106 12	12	10	48	10
A106 14	14	12	53	10

**A126**

PLUG / **BOUCHON** / TAPPO

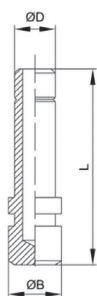

CODE	ØD	ØB	L	min.pcs.
A126 4	4	5	25,5	10
A126 5	5	6	26,5	10
A126 6	6	7	27,5	10
A126 8	8	9	30	10
A126 10	10	11	35	10
A126 12	12	13	37	10
A126 14	14	15	39,5	10

**A108**

REDUCER / **REDUCTION** / RIDUZIONE

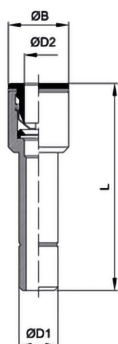

CODE	ØD1	ØD2	ØB	L	min.pcs.
A108 5-4	5	4	9	33	10
A108 6-4	6	4	9	30	10
A108 6-5	6	5	9,5	35,5	10
A108 8-4	8	4	9	32	10
A108 8-5	8	5	10	32,5	10
A108 8-6	8	6	11	33	10
A108 10-6	10	6	11	37,5	10
A108 10-8	10	8	13	38,5	10
A108 12-4	12	4	13	40	10
A108 12-6	12	6	13	40	10
A108 12-8	12	8	13	39	10
A108 12-10	12	10	15	41	10
A108 14-4	14	4	9	43,5	10
A108 14-6	14	6	11	43,5	10
A108 14-8	14	8	13	43,5	10
A108 14-10	14	10	15	43,5	10
A108 14-12	14	12	17	44	10

**A127**

EXTENSION / **AUGMENTATION** / ESTENSIONE

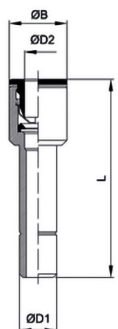

CODE	ØD1	ØD2	ØB	L	min.pcs.
A127 4-6	4	6	11	35	10
A127 6-8	6	8	13	38,5	10

**A128**

ELBOW CONNECTOR / **COUDE ENCLIQUETABLE** / GOMITO CODOLO

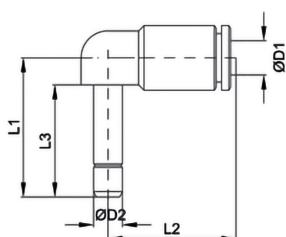

CODE	ØD1	ØD2	L1	L2	L3	min.pcs.
A128 4	4	4	20	17,5	16	10
A128 6	6	6	26	19,5	18	10
A128 8	8	8	31	23	19,5	10
A128 10	10	10	35,5	24	24	10
A128 12	12	12	41	27	25	10
Reduced / Réduit / Riduzione						
A128 6-4	4	6	29	20	18	10
A128 8-6	6	8	30,5	21,5	19,5	10

**A134**

ELBOW CONNECTOR LONG / **COUDE ENCLIQUETABLE** / GOMITO CODOLO LUNGO

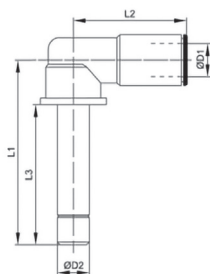

CODE	ØD1	ØD2	L1	L2	L3	min.pcs.
A134 4	4	4	31,5	19,0	23,0	10
A134 6	6	6	43,0	21,0	32,0	10
Reduced / Réduit / Riduzione						
A134 6-4	4	6	43	20	32	10
A134 8-6	6	8	45	21	34	10

**A135**

CARTRIDGE / **CARTOUCHE** / CARTUCCIA

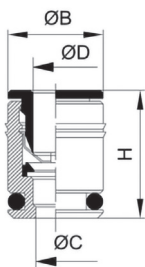

CODE	ØD	ØC	ØB	H	min.pcs.
A135 4	4	2,9	9,2	16,5	10
A135 6	6	5	11,2	17,5	10
A135 8	8	7	13,2	19,5	10
A135 10	10	8	15,2	21	10

**A194**

FEMALE PLUG / **BOUCHON FEMELLE** / TAPPO FEMMINA



CODE	ØD	ØB	L	min.pcs.
A194 4	4	9	16	10
A194 6	6	11	17,5	10
A194 8	8	13	20,5	10
A194 10	10	15	19,5	10
A194 12	12	17	22,2	10

**A136**

TUBE CONNECTOR / **TUBE CONNECTEUR** / CODOLO PORTAGOMMA

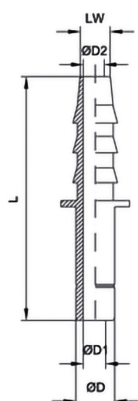

CODE	ØD	ØD1	ØD2	LW	L	min.pcs.
A136 6-LW6	6	4	4	6	36,5	10
A136 8-LW6	8	6	5	6	38	10
A136 8-LW8	8	6	6	8	43	10
A136 12-LW13	12	10	10	13	57	10
A136 14-LW14	14	12	11	13	60	10

**A140**

SINGLE SCREW / VIS SIMPLE / VITE CAVA SINGOLA

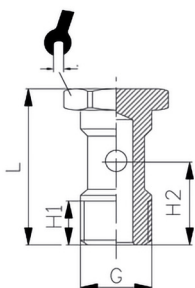

CODE	G	H1	H2	L		min.pcs.
A140 M5	M5	6	9,6	17,5	8	10
A140 M6	M6	7,5	10,5	19	8	10
A140 1/8	G1/8	6,5	15	28	14	10
A140 1/4	G1/4	12	18	33	17	10
A140 3/8	G3/8	13,5	21	36	19	10
A140 1/2	G1/2	15	23,5	42	24	10

**A141**

DOUBLE SCREW / VIS DOUBLE / VITE CAVA DOPPIA

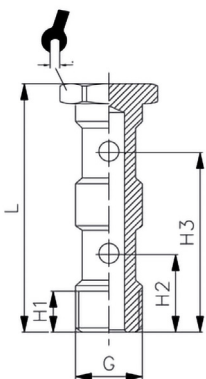

CODE	G	H1	H2	H3	L		min.pcs.
A141 1/8	G1/8	9	15	31	44,5	14	10
A141 1/4	G1/4	11	17	36	51,5	17	10
A141 3/8	G3/8	14	20,5	43	58,1	19	10
A141 1/2	G1/2	15,5	23,5	49,5	68	24	10

**A142**

TRIPLE SCREW / VIS TRIPLE / VITE CAVA TRIPLA

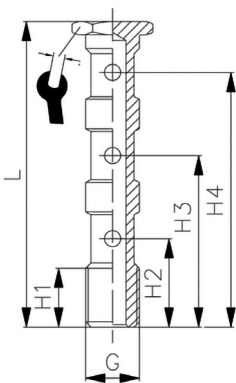

CODE	G	H1	H2	H3	H4	L		min.pcs.
A142 1/8	G1/8	9	16	32	48	60	14	10
A142 1/4	G1/4	12	18,5	37	55,5	70,5	17	10
A142 3/8	G3/8	13	20,5	44	65	80	19	10
A142 1/2	G1/2	16	25	51	70,5	94	24	10

**A145**

RELEASE KEY / CLÉ DE DÉBLOCAGE / CHIAVE DI SGANCIO

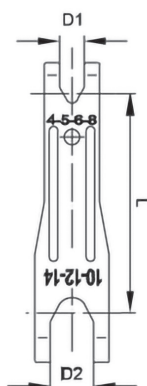

CODE	ØD1	ØD2	L
A145	8	14	93