

The cylinders on which it is possible to assemble the oval switch are:  
**Les vérins sur lesquels vous pouvez monter le capteur ovale sont:**  
I cilindri su cui è possibile montare il sensore ovale sono:

- CF Cylinders ISO 15552 / **Vérins ISO 15552** / Cilindri ISO 15552
- CY Cylinders ISO 15552 / **Vérins ISO 15552** / Cilindri ISO 15552
- CZ Cylinders ISO 15552 / **Vérins ISO 15552** / Cilindri ISO / 5552
- CA Twin rod cylinders / **Vérins bitiges** / Cilindri ad aste gemellate
- CM Compact cylinders ISO 21287 / **Vérins compact ISO 21287** / Cilindri compatti ISO 21287
- CC Guide compact cylinders / **Vérins compacts guide** / Cilindri compatti guidati
- SS Rodless cylinders / **Vérins sans tige** / Cilindri senza stelo
- RY Rotary cylinders / **Vérins rotatifs** / Cilindri rotanti

## TECHNICAL DATA / DONNÉES TECHNIQUES / DATI TECNICI

	REED	HALL
Sensor type / <b>Type de capteur</b> / Tipo sensore	Reed NA / NO	PNP NA/NO
Protection class / <b>Grade de protection</b> / Grado di protezione	IP 67	IP 67
Working temp. / <b>Température de travail</b> / Temperatura di impiego	-10°C + 70°C	-10°C + 70°C
Housing material / <b>Matière</b> / Materiale custodia	PA	PA
Sheath material / <b>Matière de la gaine</b> / Materiale guaina	PVC	PVC
Power supply / <b>Tension d'alimentation</b> / Tensione di alimentazione	3-30 VAC/VDC	Hall 6-30 VDC
Switching current / <b>Courant de commutation</b> / Corrente di commutazione	0,2 A	0,2 A
ON voltage drop / <b>Surtension tension</b> / Caduta di tensione	< 3 V	< 1 V
Nominal operate poin / <b>Point de travail nominal</b> / Punto di lavoro nominale	20-25 AT	40 Gauss (34- 46 Gauss)
ON-OFF differential / <b>Différenciel ON-OFF</b> / Differenza ON-OFF	5 - 10 AT	5 - 15 Gauss
On time / <b>Temps d'ouverture</b> / Tempo inserzione	0,5mS	0,8 uS
Off time / <b>Temps de fermeture</b> / Tempo disinserzione	0,1mS	0,3 uS
Wiring schematics / <b>Configuration du circuit</b> / Configurazione circuiti		

M8 connector / **Connecteur M8** / Connettore M8

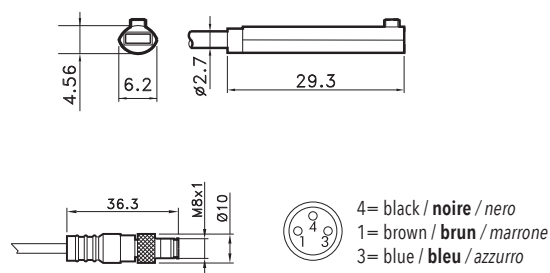
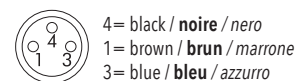
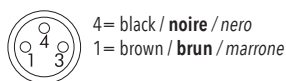

### OVAL SWITCH / CAPTEUR OVAL / SENSORE OVALE

#### CODE

- AR4019010** REED (MT,2,5) / **REED (MT,2,5)** / REED (MT,2,5)
- AR4019020** HALL (MT,2,5) / **HALL (MT,2,5)** / HALL (MT,2,5)
- AR4019110** REED + M8 (CM 30) / **REED + M8** / REED + M8 (CM 30)
- AR4019120** HALL + M8 (CM 30) / **HALL + M8** / HALL + M8 (CM 30)

### EXTENSION CABLE 2,5 mt / EXTENSION CABLES 2,5 mt / PROLUNGA CAVO 2,5 mt

#### CODE

- AR4300** WITH M8 2 WIRES / **AVEC M8 2 CÂBLES** / CON M8 2 FILI
- AR4301** WITH M8 3 WIRES / **AVEC M8 3 CÂBLES** / CON M8 3 FILI

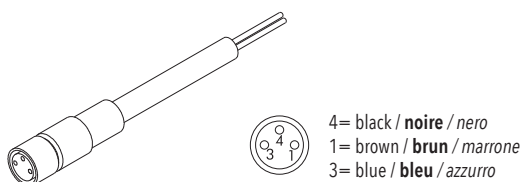

### MOUNTING / MONTAGE / MONTAGGIO

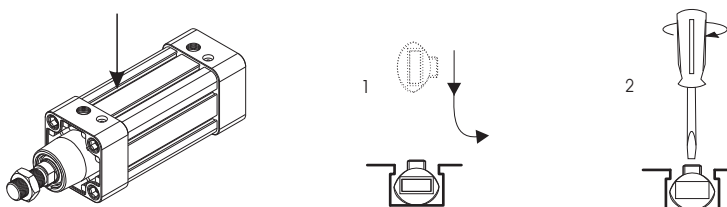



The cylinders on which it is possible to assemble the T switch are:  
**Les vérins sur lesquels vous pouvez monter le capteur en T sont:**  
*I cilindri su cui è possibile montare il sensore a T sono:*

- CG Cylinders ISO 15552 / **Vérins ISO 15552** / *Cilindri ISO 15552*
- MC Cylinders ISO 6432 / **Vérins ISO 6432** / *Cilindri ISO 6432*
- MX Cylinders ISO 6432 stainless steel / **Vérins ISO 6432 inox** / *Cilindri ISO 6432 Inox*
- CT Round cylinders / **Vérins ronds** / *Cilindri tondi*
- CO Cylinders ISO 15552 (160-200-250) / **Vérins ISO 15552 (160-200-250)** / *Cilindri ISO 15552 (160-200-250)*
- CM Compact cylinders ISO 21287 / **Vérins compacts ISO 21287** / *Cilindri compatti ISO 21287*
- CX Cylinders ISO 15552 stainless steel / **Vérins ISO 15552 inox** / *Cilindri ISO 15552 Inox*
- CC Guide compact cylinders / **Vérins compacts guide** / *Cilindri compatti guidati*
- SS Rodless cylinders / **Vérins sans tige** / *Cilindri senza stelo*
- BS Rod locks / **Bloqueurs de tige** / *Bloccasteli*
- ST Stopper cylinders / **Vérins stoppeur** / *Cilindri stopper*

## TECHNICAL DATA / DONNÉES TECHNIQUES / DATI TECNICI

	REED	HALL
Sensor type / <b>Type de capteur</b> / <i>Tipo sensore</i>	Reed NA / NO	PNP NA/NO
Protection class / <b>Grade de protection</b> / <i>Grado di protezione</i>	IP 67	IP 67
Working temp. / <b>Température de travail</b> / <i>Temperatura di impiego</i>	-10°C + 70°C	-10°C + 70°C
Housing material / <b>Matière</b> / <i>Materiale custodia</i>	PA	PA
Sheath material / <b>Matière de la gaine</b> / <i>Materiale guaina</i>	PVC	PVC
Power supply / <b>Tension d'alimentation</b> / <i>Tensione di alimentazione</i>	3-30 VAC/VDC	Hall 6-30 VDC
Switching current / <b>Courant de commutation</b> / <i>Corrente di commutazione</i>	0,2 A	0,2 A
ON voltage drop / <b>Surtension tension</b> / <i>Caduta di tensione</i>	< 3 V	< 1 V
Nominal operate poin / <b>Point de travail nominal</b> / <i>Punto di lavoro nominale</i>	20-25 AT	40 Gauss (34- 46 Gauss)
ON-OFF differential / <b>Différenciel ON-OFF</b> / <i>Differenza ON-OFF</i>	5 - 10 AT	5 - 15 Gauss
On time / <b>Temps d'ouverture</b> / <i>Tempo inserzione</i>	0,5mS	0,8 uS
Off time / <b>Temps de fermeture</b> / <i>Tempo disinserzione</i>	0,1mS	0,3 uS
Wiring schematics / <b>Configuration du circuit</b> / <i>Configurazione circuiti</i>		
M8 connector / <b>Connecteur M8</b> / <i>Connettore M8</i>		

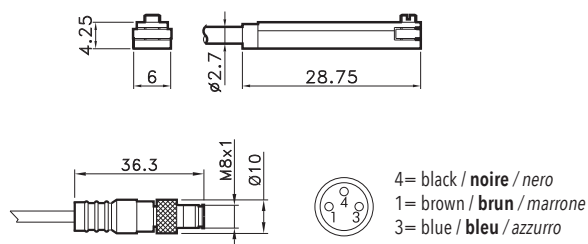

### T SWITCH / CAPTEUR EN T / SENSORE AT

- CODE**
- AR4023010** REED (MT.2,5) / **REED (MT.2,5)** / *REED (MT.2,5)*
  - AR4023020** HALL (MT.2,5) / **HALL (MT.2,5)** / *HALL (MT.2,5)*
  - AR4023110** REED + M8 (CM 30) / **REED + M8** / *REED + M8 (CM 30)*
  - AR4023120** HALL + M8 (CM 30) / **HALL + M8** / *HALL + M8 (CM 30)*

### EXTENSION CABLE 2,5 mt / EXTENSION CABLES 2,5 mt / PROLUNGA CAVO 2,5 mt

- CODE**
- AR4300** WITH M8 2 WIRES / **AVEC M8 2 CÂBLES** / *CON M8 2 FILI*
  - AR4301** WITH M8 3 WIRES / **AVEC M8 3 CÂBLES** / *CON M8 3 FILI*

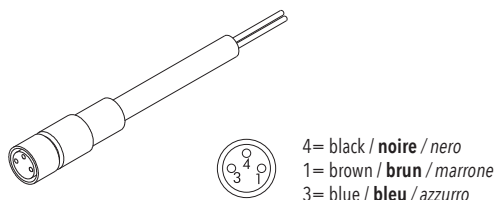

### MOUNTING / MONTAGE / MONTAGGIO

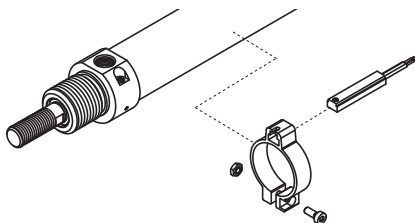



The products on which it is possible to assemble the round switch are:  
**Les produit sur lesquels vous pouvez monter le capteur rond sont:**  
*I prodotti su cui è possibile montare il sensore tondo sono:*

- PA Angular grippers / **Pince angulaire** / Pinze angolari
- PG Angular grippers 180° / **Pince angulaire 180°** / Pinze angolari a 180°
- PS Guided parallel grippers / **Pinces parallèles guidée** / Pinze parallele guidata
- PH Parallel grippers with long stroke / **Pinces parallèles avec longue course** / Pinze parallele a grande apertura
- PX Parallel grippers with 3 fingers / **Pinces parallèles avec 3 doigts** / Pinze parallele a 3 griffe
- AT Rotary actuators / **Actionneurs rotatifs** / Attuatori rotanti
- CD Short stroke cylinders / **Vérins course brève** / Cilindri corsa breve

## TECHNICAL DATA / DONNÉES TECHNIQUES / DATI TECNICI

	REED	HALL
Sensor type / <b>Type de capteur</b> / Tipo sensore	Reed NA/ NO	PNP NA/NO
Protection class / <b>Grade de protection</b> / Grado di protezione	IP 67	IP 67
Working temp. / <b>Température de travail</b> / Temperatura di impiego	-10°C + 70°C	-10°C + 70°C
Housing material / <b>Matière</b> / Materiale custodia	PA	PA
Sheath material / <b>Matière de la gaine</b> / Materiale guaina	PVC	PVC
Power supply / <b>Tension d'alimentation</b> / Tensione di alimentazione	3-30 VAC/VDC	Hall 6-30 VDC
Switching current / <b>Courant de commutation</b> / Corrente di commutazione	0,2 A	0,2 A
ON voltage drop / <b>Surtension tension</b> / Caduta di tensione	< 3 V	< 1 V
Nominal operate poin / <b>Point de travail nominal</b> / Punto di lavoro nominale	20-25 AT	28 Gauss (21- 35 Gauss)
ON-OFF differential / <b>Différenciel ON-OFF</b> / Differenza ON-OFF	5 - 10 AT	5 - 15 Gauss
On time / <b>Temps d'ouverture</b> / Tempo inserzione	0,5mS	0,8 uS
Off time / <b>Temps de fermeture</b> / Tempo disinserzione	0,1mS	0,3 uS

Wiring schematics / **Configuration du circuit** / Configurazione circuiti

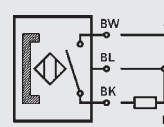
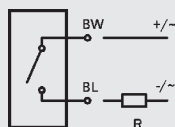

M8 connector / **Connecteur M8** / Connettore M8

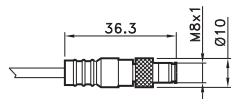
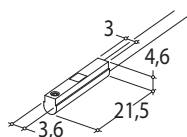
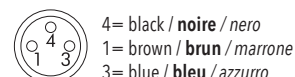
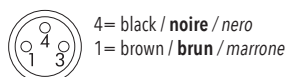

4= black / **noire** / nero  
1= brown / **brun** / marrone  
3= blue / **bleu** / azzurro

## ROUND SWITCH / CAPTEUR ROND / SENSORE TONDO

### CODE

- AR4018010** REED (MT.2,5) / **REED (MT.2,5)** / REED (MT.2,5)
- AR4018020** HALL (MT.2,5) / **HALL (MT.2,5)** / HALL (MT.2,5)
- AR4018110** REED + M8 (CM 30) / **REED + M8** / REED + M8 (CM 30)
- AR4018120** HALL + M8 (CM 30) / **HALL + M8** / HALL + M8 (CM 30)

## EXTENSION CABLE 2,5 mt / EXTENSION CABLES 2,5 mt / PROLUNGA CAVO 2,5 mt

### CODE

- AR4300** WITH M8 2 WIRES / **AVEC M8 2 CÂBLES** / CON M8 2 FILI
- AR4301** WITH M8 3 WIRES / **AVEC M8 3 CÂBLES** / CON M8 3 FILI

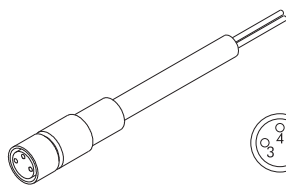

4= black / **noire** / nero  
1= brown / **brun** / marrone  
3= blue / **bleu** / azzurro